

AA 系列转角型喷嘴

空心锥形喷嘴/转角型

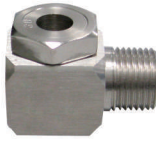

内螺纹(A)



外螺纹(AA)



发电厂脱硫塔喷淋



汽车喷漆前处理喷淋

性能数据

标准角

喷嘴入口接头	流量代码	喷嘴型号		材料代码			主体入口直径 (毫米)	额定喷嘴孔径 (毫米)	流量 (升/分钟)												喷射角度		
		AA	A	BRASS	SS	316SS			0.2巴	0.5巴	1巴	1.5巴	2巴	3巴	4巴	5巴	6巴	7巴	0.5巴	1.5巴	6巴		
		1/8	0.5	●	●	●			●	●	0.79	1.2	0.16	0.23	0.28	0.32	0.39	0.46	0.51	0.56	0.60		58°
1/8	1	●	●	●	●	●	1.6	1.6	0.32	0.46	0.56	0.64	0.79	0.91	1.0	1.1	1.2		64°	76°			
	2	●	●	●	●	●	2.0	2.0	0.64	0.91	1.1	1.3	1.6	1.8	2.0	2.2	2.4	52°	61°	69°			
	3	●	●	●	●	●	2.4	2.4	0.97	1.4	1.7	1.9	2.4	2.7	3.1	3.3	3.6	52°	64°	77°			
	5	●	●	●	●	●	3.2	3.2	1.0	1.6	2.3	2.8	3.2	3.9	4.6	5.1	5.6	6.0	56°	67°	76°		
	8	●	●	●	●	●	4.0	4.0	1.6	2.6	3.6	4.5	5.2	6.3	7.3	8.2	8.9	9.6	56°	65°	70°		
	10	●	●	●	●	●	4.4	4.4	2.0	3.2	4.6	5.6	6.4	7.9	9.1	10.2	11.2	12.1	55°	65°	72°		
1/4	1	●	●	●	●	●	1.6	1.6	0.46	0.56	0.64	0.79	0.91	1.0	1.1	1.2		53°	67°				
	2	●	●	●	●	●	2.0	2.0	0.64	0.91	1.1	1.3	1.6	1.8	2.0	2.2	2.4		62°	71°			
	3	●	●	●	●	●	2.4	2.4	0.97	1.4	1.7	1.9	2.4	2.7	3.1	3.3	3.6	51°	65°	78°			
	5	●	●	●	●	●	3.6	3.6	1.0	1.6	2.3	2.8	3.2	3.9	4.6	5.1	5.6	6.0	63°	73°	79°		
	8	●	●	●	●	●	4.0	4.0	1.6	2.6	3.6	4.5	5.2	6.3	7.3	8.2	8.9	9.6	61°	69°	73°		
	10	●	●	●	●	●	4.8	4.4	2.0	3.2	4.6	5.6	6.4	7.9	9.1	10.2	11.2	12.1	63°	70°	74°		
3/8	15	●	●	●	●	●	5.9	5.2	3.1	4.8	6.8	8.4	9.7	11.8	13.7	15.1	16.7	18.1	63°	71°	72°		
	5	●	●	●	●	●	3.6	3.2	1.0	1.6	2.3	2.8	3.2	3.9	4.6	5.1	5.6	6.0	64°	73°	79°		
	8	●	●	●	●	●	4.4	4.0	1.6	2.6	3.6	4.5	5.2	6.3	7.3	8.2	8.9	9.6	62°	70°	74°		
	10	●	●	●	●	●	5.2	4.4	2.0	3.2	4.6	5.6	6.4	7.9	9.1	10.2	11.2	12.1	64°	72°	75°		
	15	●	●	●	●	●	5.9	5.6	3.1	4.6	6.8	8.4	9.7	11.8	13.7	15.3	16.7	18.1	64°	72°	74°		
	20	●	●	●	●	●	7.1	6.4	4.1	6.4	9.1	11.2	12.9	15.8	18.2	20	22	24	63°	70°	74°		
1/2	25	●	●	●	●	●	7.5	7.5	5.1	8.1	11.4	14.0	16.1	19.7	23	25	28	30	63°	70°	74°		
	30	●	●	●	●	●	8.3	7.9	6.1	9.7	13.7	16.7	19.3	24	27	31	33	36	63°	70°	74°		
	25	●	●	●	●	●	9.5	6.4	5.1	8.1	11.4	14.0	16.1	19.7	23	25	28	30	63°	66°	71°		
	30	●	●	●	●	●	9.5	7.5	6.1	9.7	13.7	16.7	19.3	24	27	31	33	36	67°	71°	75°		
	40	●	●	●	●	●	9.5	9.1	8.2	12.9	18.2	22	26	32	36	41	45	48	72°	76°	78°		
	50	●	●	●	●	●	9.5	11.1	10.2	16.1	23	28	32	39	46	51	56	60	74°	79°	82°		
60	●	●	●	●	●	9.5	13.1	12.2	19.3	27	33	39	47	55	61	67	72	77°	82°	86°			

AA/A 系列金属喷嘴的特点是能产生空心锥形喷雾形状,喷射区域成环形,喷雾角度为51°-114°。

该类喷嘴能在大范围的流率和压力下产生分布均匀,液滴大小为小到中等的喷雾。即使是在低压条件下,AA/A系列金属喷嘴亦能对液体进行良好的雾化应用极产生极佳效果。对于要求快速热交换或要求有效的空悬液滴的冲击应用中,这种效果尤其明显。

AA/A 系列金属喷嘴具有独特的旋流腔结构,其大而通畅的流通道,能减少或消除阻塞现象。

AA 系列金属喷嘴为外螺纹接头,A系列金属喷嘴为内螺纹接头。

一般应用

- 气体洗涤与冷却
- 水冷却
- 灭尘控制
- 金属处理
- 化学反应处理
- 其它热交换应用

订购信息

AA 1/4—SS 10

↓ ↓ ↓ ↓
喷嘴 入口 材料 流量
型号 接头 代码 代码

备注:BRASS—黄铜

SS— 不锈钢

316SS—316 不锈钢

广角

喷嘴入口接头	流量代码	喷嘴型号		材料代码			主体入口直径 (毫米)	额定喷嘴孔径 (毫米)	流量 (升/分钟)												喷射角度		
		AA	A	BRASS	SS	316SS			0.2巴	0.5巴	1巴	1.5巴	2巴	3巴	4巴	5巴	6巴	7巴	0.5巴	1.5巴	6巴		
		1/8	0.5-0.5W	●	●	●			●	●	0.79	1.2			0.23	0.28	0.32	0.39	0.46	0.51	0.56	0.6	
1/8	1-1W	●	●	●	●	●	1.6	1.6			0.46	0.56	0.64	0.79	0.91	1.0	1.1	1.2		125°	110°		
	2-3W	●	●	●	●	●	2.0	2.8		0.81	1.1	1.4	1.6	2.0	2.3	2.5	2.8	2.9	114°	114°	97°		
	3-3W	●	●	●	●	●	2.4	2.8		0.97	1.4	1.7	1.9	2.4	2.7	3.1	3.3	3.7	114°	114°	97°		
	3-5W	●	●	●	●	●	2.4	3.2		1.1	1.5	1.9	2.2	2.7	3.1	3.5	3.8	4.0	116°	110°	95°		
	2-10W	●	●	●	●	●	2.0	4.4		1.3	1.9	2.3	2.6	3.2	3.7	4.2	4.6	5.0	130°	135°	120°		
	5-5W	●	●	●	●	●	3.2	3.2		1.6	2.3	2.8	3.2	3.9	4.6	5.1	5.5	6.1	116°	110°	92°		
1/4	5-10W	●	●	●	●	●	3.2	4.4	1.3	2.1	3.0	3.6	4.2	5.1	5.9	6.6	7.3	7.9	126°	121°	95°		
	8-10W	●	●	●	●	●	4.0	4.4	1.8	2.9	4.1	5.0	5.8	7.1	8.2	9.2	10.0	10.8	124°	112°	90°		
	1-1W	●	●	●	●	●	1.6	1.6		0.46	0.56	0.64	0.79	0.91	1.0	1.1	1.2		117°	111°			
	1-5W	●	●	●	●	●	1.6	3.2		0.77	0.95	1.1	1.3	1.5	1.7	1.9	2.0		123°	124°			
	1-10W	●	●	●	●	●	1.6	4.4		0.96	1.2	1.4	1.7	1.9	2.1	2.3	2.5		144°	139°			
	1-15W	●	●	●	●	●	1.6	5.6		1.1	1.3	1.5	1.9	2.2	2.4	2.7	2.9		128°	132°			
3/8	2-5W	●	●	●	●	●	2.0	3.2		1.1	1.5	1.9	2.2	2.7	3.1	3.5	3.8	4.0	118°	123°	113°		
	2-10W	●	●	●	●	●	2.0	4.4		1.3	1.9	2.3	2.6	3.2	3.7	4.2	4.6	5.0	138°	136°	126°		
	5-5W	●	●	●	●	●	3.6	3.2		1.6	2.3	2.8	3.2	3.9	4.6	5.1	5.6	6.1	114°	113°	104°		
	5-10W	●	●	●	●	●	3.6	4.4	1.3	2.1	3.0	3.6	4.2	5.1	5.9	6.6	7.3	7.9	130°	130°	119°		
	5-15W	●	●	●	●	●	3.6	5.6	1.6	2.5	3.5	4.3	5.0	6.1	7.0	7.8	8.6	9.3	130°	132°	120°		
	8-10W	●	●	●	●	●	4.0	4.4	1.8	2.9	4.1	5.0	5.8	7.1	8.2	9.2	10.0	10.8	129°	122°	103°		
1/2	10-10W	●	●	●	●	●	4.8	4.4	2.0	3.2	4.6	5.6	6.4	7.9	9.1	10.2	11.2	12.2	120°	108°	95°		
	8-15W	●	●	●	●	●	4.0	5.6	2.2	3.5	5.0	6.1	7.1	8.7	10.0	11.2	12.3	13.2	129°	122°	107°		
	10-15W	●	●	●	●	●	4.8	5.6	2.4	3.9	5.5	6.7	7.7	9.5	10.9	12.2	13.4	14.6	120°	108°	97°		
	15-15W	●	●	●	●	●	4.0	5.6	3.0	4.8	6.8	8.4	9.7	11.8	13.7	15.3	16.7	18.0	101°	95°	90°		
	5-10W	●	●	●	●	●	4.8	4.4	1.3	2.1	3.0	3.6	4.2	5.1	5.9	6.6	7.3	7.9	130°	123°	102°		
	5-15W	●	●	●	●	●	6.0	5.6	1.6	2.5	3.5	4.3	5.0	6.1	7.0	7.8	8.6	9.3	138°	131°	112°		
3/8	8-10W	●	●	●	●	●	3.6	4.4	1.8	2.9	4.1	5.0	5.8	7.1	8.2	9.2	10.0	10.8	122°	110°	96°		
	10-10W	●	●	●	●	●	3.6	4.4	2.0	3.2	4.6	5.6	6.4	7.9	9.1	10.2	11.2	12.2	116°	108°	93°		
	8-15W	●	●	●	●	●	4.4	5.6	2.2	3.5	5.0	6.1	7.1	8.7	10.0	11.2	12.3	13.2	133°	120°	105°		
	10-15W	●	●	●	●	●	5.2	5.6	2.4	3.9	5.5	6.7	7.7	9.5	10.9	12.2	13.4	14.6	126°	115°	100°		
	8-25W	●	●	●	●	●	4.4	7.5	2.6	4.2	5.9	7.3	8.4	10.3	11.9	13.3	14.5						